

EF

EFR



GEARBOX VERSION

Versión con reductor / Ausführung mit Getriebe / Versione con riduttore / Version avec réducteur



SYMMETRICAL - REVERSIBLE CARTER

CÁRTER SIMÉTRICO - REVERSIBLE
 SYMMETRISCHES GEHÄUSE - REVERSIBEL
 CARTER SIMMETRICO - REVERSIBILE
 CARTER SYMÉTRIQUE - RÉVERSIBLE



FLUID END
AISI 420

FLUID END
AISI 316

MAX 200 BAR

EF | EFR

CONNECTION KIT

KIT DE CONEXION / ANSCHLUSS KIT / KIT CONNESSIONI / KIT DE RACCORDEMENT

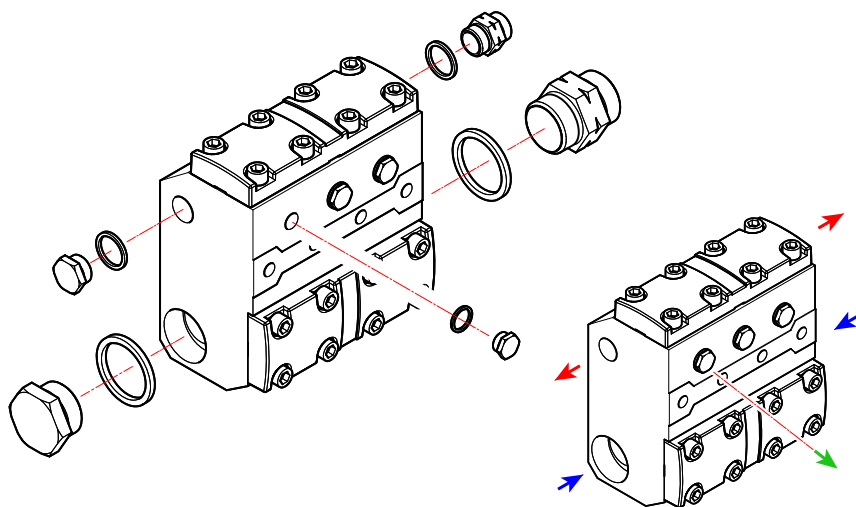

← Outlet		2803 0591	1" G
		2803 0597	1" - 3/4" G
		2803 0598	1" - 1/2" G
		3202 0387	1" G
→ Inlet		2803 0594	1 1/2 G - Ø 40
		2803 0601	1 1/2 G - Ø 50
		2803 0703	1 1/2 G
		3200 0174	1 1/2 G
		2803 0599	2" G - Ø 50
		2803 0592	2" G - Ø 50
		2803 0704	2" G
		3200 0175	2" G
↑ Manom.		3200 0212	1/2" G
		2803 0699	1/2" G
		2803 0700	1/2" - 3/8" G

Modello Model	Inlet →	Outlet ←
75/280 - 88/250 - 111/210 - 127/180	1 1/2"	1/2"
123/150 - 139/150 - 154/150 - 165/120 - 183/210	2"	



OVERALL DIMENSION

MEDIDAS MÁXIMA / GESAMTABMESSUNGEN / DIMENSIONI D'INGOMBRO / DIMENSION

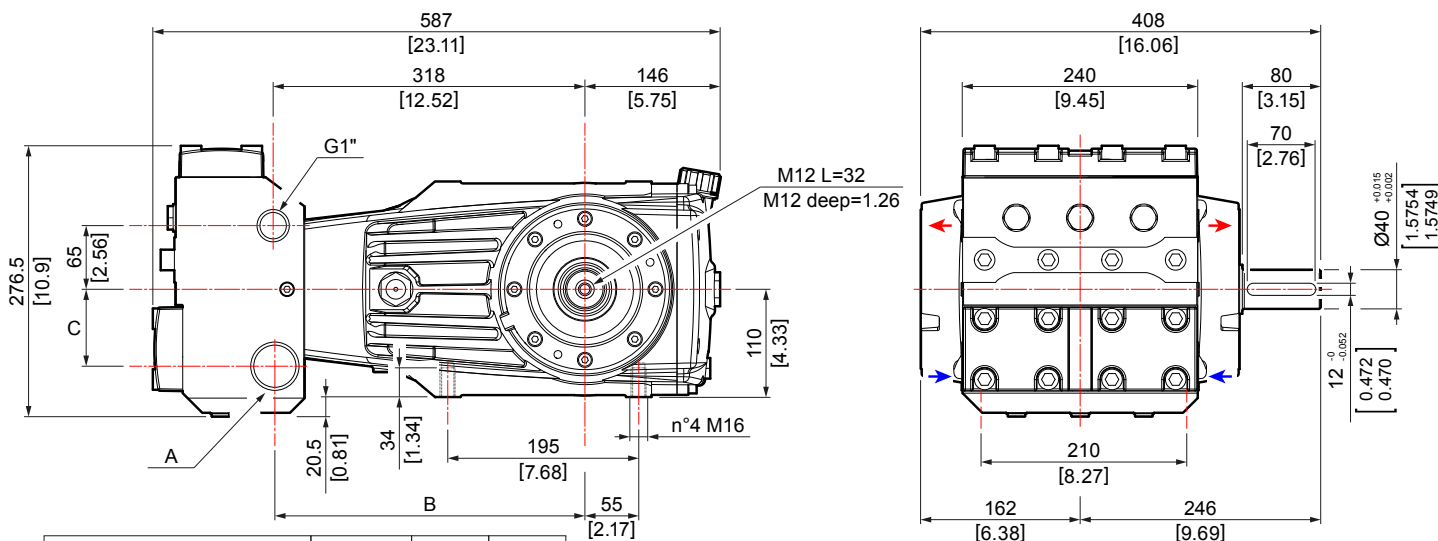

Modello Model	A	B	C
75/280 - 88/250 - 111/210 127/180	G1 1/2"	316.5 [12.46]	78.5 [3.09]
123/150 - 139/150 - 154/150 165/120 - 183/120	G2"	321.5 [12.66]	71.5 [2.81]



OVERALL DIMENSION

MEDIDAS MÁXIMA / GESAMTABMESSUNGEN / DIMENSIONI D'INGOMBRO / DIMENSION

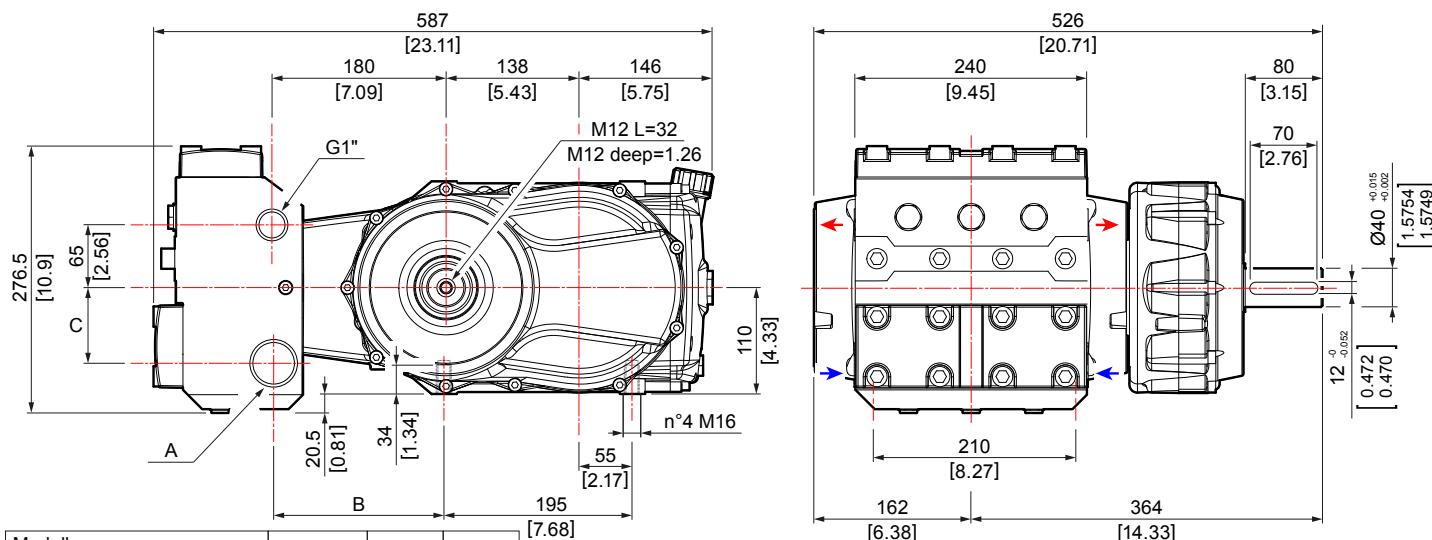

Modello Model	A	B	C
88/250 - 111/210 - 127/180	G1 1/2"	176.5 [6.95]	78.5 [3.09]
123/150 - 139/150 - 154/150 165/120 - 183/120	G2"	181.5 [7.15]	71.5 [2.81]



FEMALE SPLINED SHAFT (OPTIONAL)

EJE ACANALADO HEMBRA (OPCIONAL) / WEIBLICHE KEILWELLE (OPTIONAL) / ALBERO SCANALATO FEMMINA (OPZIONALE) / ARBRE CANNELÉ FEMELLE (OPTIONNEL)

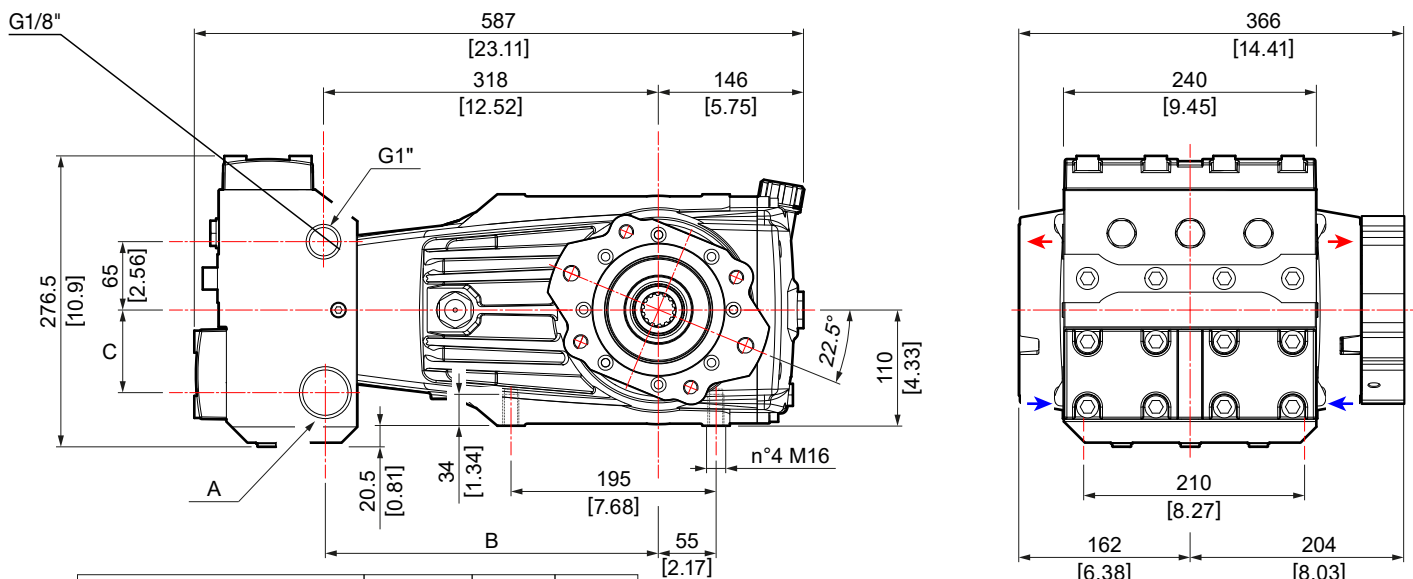

Modello Model	A	B	C
75/280 - 88/250 - 111/210 127/180	G1 1/2"	316.5 [12.46]	78.5 [3.09]
123/150 - 139/150 - 154/150 165/120 - 183/120	G2"	321.5 [12.66]	71.5 [2.81]



HYDRAULIC MOTOR-PUMP GROUP VERSION

AVAILABLE WITH PISTON-MOTOR 80CC OR 90CC / DISPONIBILE CON MOTOR DE PISTÓN 80CC O 90 CC / ERHÄLTLICH MIT KOLBENMOTOR 80CC ODER 90CC / DISPONIBILE CON MOTORE IDRAULICO A PISTONI 80CC O 90CC / DISPONIBILE AVEC MOTEUR A PISTON 80CC OU 90CC

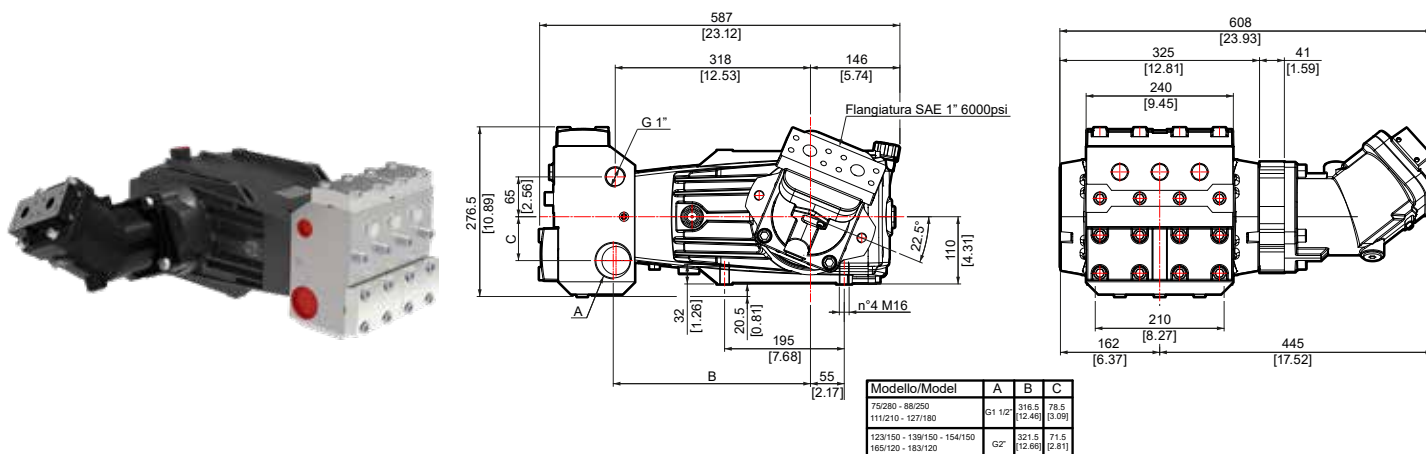

Modello/Model	A	B	C
75/280 - 88/250 111/210 - 127/180	G1 1/2"	316.5 [12.46]	78.5 [3.09]
123/150 - 139/150 - 154/150 165/120 - 183/120	G2"	321.5 [12.66]	71.5 [2.81]